

Specificatii

Tensiune nominala	12V	
Capacitate nominala (15min)	130W / Celula	
Dimensiuni	Lungime	195 ± 2mm
	Latime	130 ± 2mm
	Inaltime carcasa	155 ± 2mm
	Inaltime totala (cu borne)	167 ± 2mm
Greutate	Approx 11,5kg	
Tip Borna	T14	
Material carcasa	ABS	
Capacitate	33,0Ah / 3,30A	10Hr, 1,80V/cell, 25°C
	29,70Ah / 5,94A	5Hr, 1,75V/cell, 25°C
	25,44Ah / 8,48A	3Hr, 1,75V/cell, 25°C
	23,9Ah / 23,9A	1Hr, 1,6V/cell, 25°C
	130W / celula	15 min, 1,67V/cell, 25°C
Curent maxim de descarcare	330A (5s)	
Rezistenta interna	Approx 8mΩ	
Interval temp. de utilizare	Descarcare: -20 ÷ 50°C	
	Incarcare: -20 ÷ 50°C Depozitare: -20 ÷ 50°C	
Temp. nominala de utilizare	25 ± 3°C	
Utilizare ciclica	Curent initial de incarcare: <9,9A. Tensiunea de incarcare: 14,50V ÷ 15,00V la 25°C. Coef. de corectie cu temp.: -30mV / °C	
Utilizare tampon (stand-by)	Curent initial de incarcare: <9,9A. Tensiunea de incarcare: 13,50V ÷ 13,80V la 25°C. Coef. de corectie cu temp.: -18mV / °C	
Influenta temperaturii asupra capacitatii	40°C	102%
	25°C	100%
	0°C	85%
Autodescercare la 25°C	1 lun	Capacitate remanenta: u y 91%
	3 luni	Capacitate remanenta: u y 91%
	6 luni	Capacitate remanenta: u y 82%
	12 luni	Capacitate remanenta: u y 82%

Gama FH / FH12-33



Utilizari si caracteristici

Tehnologie: VRLA-AGM

Surse neinteruptibile de tensiune (UPS)

Sisteme electrice de alimentare (EPS)

Sisteme de semnalizare aeriene si feroviare

Iluminat de siguranta

Statii de alimentare electrica

Sisteme de alarma si securitate

Surse de alimentare cu C.C.

EN 60896-21,-22

Durata de viata proiectata: 10 ani

Eurobat: High Performance

Bateriile din gama FOTON FH pot fi stocate

pana la 6 luni la 25°C dupa care este

recomandata o incarcare de improspatare

Descarcare cu curent constant (Amperi) la 25°C

Ufinal/Timp	10min	15min	20min	30min	45min	60min	2h	3h	4h	5h	6h
1.60V/cell	84.9	69.5	55.6	39.4	29.3	23.9	12.1	8.65	6.97	6.06	5.18
1.67V/cell	81.1	67.4	53.4	38.1	28.4	23.3	12.0	8.57	6.91	6.01	5.14
1.70V/cell	79.0	65.3	52.3	37.4	27.9	23.0	11.9	8.54	6.88	5.98	5.12
1.75V/cell	75.6	63.1	50.5	36.5	27.2	22.5	11.7	8.48	6.83	5.94	5.08
1.80V/cell	71.4	59.8	47.8	35.2	26.2	21.8	11.4	8.23	6.63	5.76	4.93

Descarcare cu putere constanta (Watts/bloc) la 25°C

Ufinal/Timp	10min	15min	20min	30min	45min	60min	2h	3h	4h	5h	6h
1.60V/cell	160	134	107	76.0	56.6	46.2	23.5	17.0	13.7	12.0	10.3
1.67V/cell	153	130	103	73.6	54.8	45.0	23.3	16.9	13.6	11.9	10.2
1.70V/cell	149	126	101	72.2	53.8	44.4	23.2	16.8	13.6	11.8	10.1
1.75V/cell	142	122	97.4	70.5	52.5	43.5	22.8	16.7	13.5	11.8	10.1
1.80V/cell	134	115	92.3	67.9	50.6	42.1	22.2	16.2	13.1	11.4	9.76

Dimensiuni exterioare (mm)

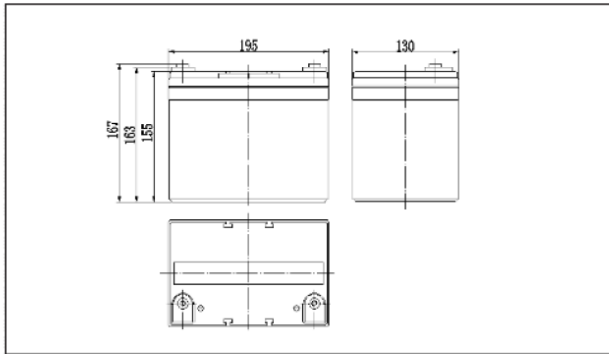

Tip Borna (mm)

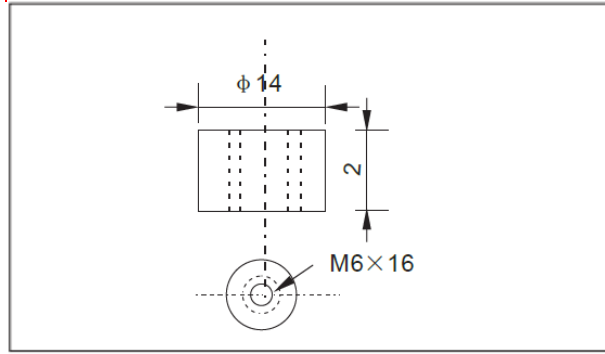

Caracteristici de descarcare (25°C)

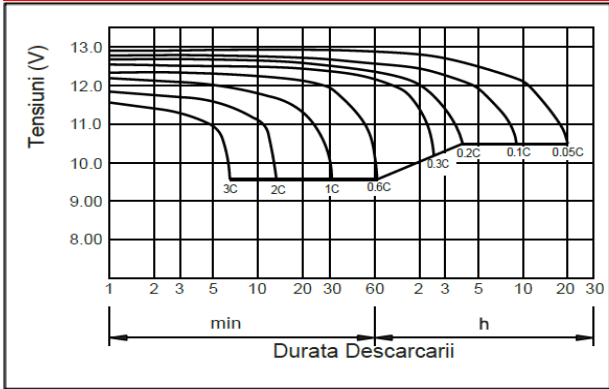

Caracteristici de incarcare (25°C)

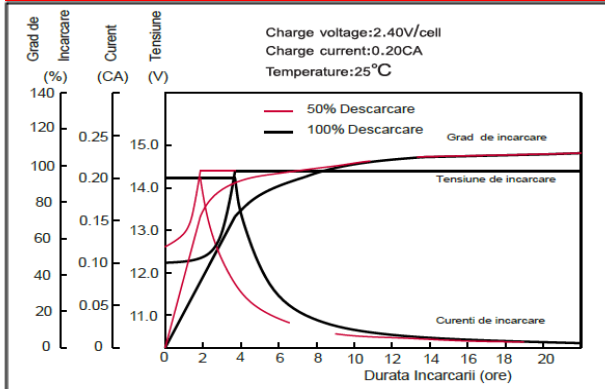

Efectul temperaturii asupra capacitatii

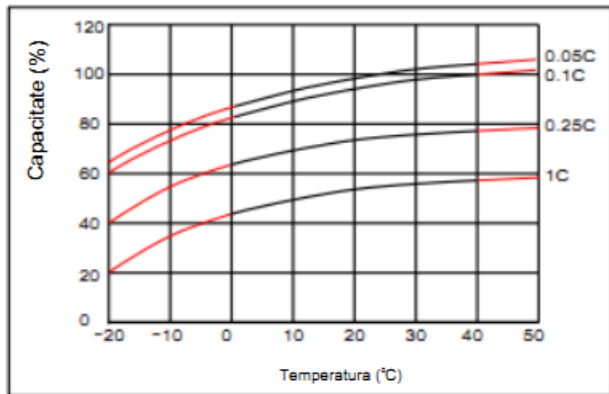

Durata de viata in functie de temperatura

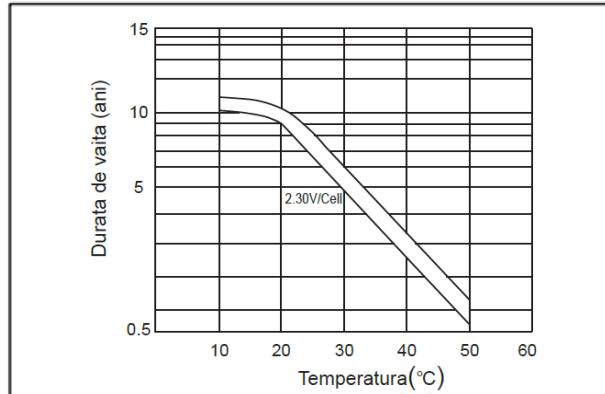

Numar de cicluri vs D.O.D (25°C)

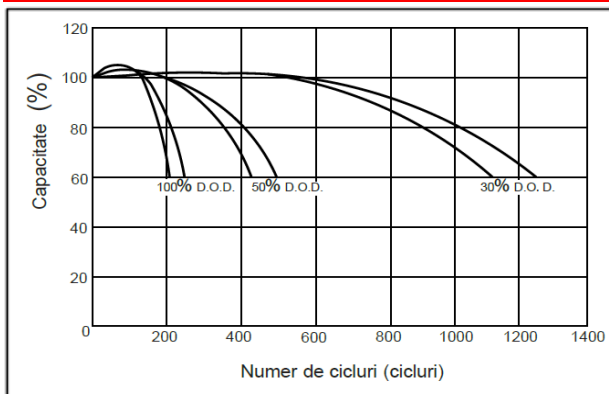

Relatia tensiune la borne / capacitate (25°C)

