

Specificatii

| | | |
|-----------------------------|--|---------------------------|
| Tensiune nominala | 12V | |
| Capacitate nominala (10h) | 80Ah | |
| Dimensiuni | Lungime | 260 ± 2mm |
| | Latime | 169 ± 2mm |
| | Inaltime carcasa | 211 ± 2mm |
| | Inaltime totala (cu borne) | 215 ± 2mm |
| Greutate | Approx 24.20kg | |
| Tip Borna | T14 | |
| Material carcasa | ABS | |
| Capacitate | 84.8Ah / 4.24A | 20Hr, 1,80V/cell, 25°C |
| | 80.0Ah / 8.00A | 10Hr, 1,80V/cell, 25°C |
| | 68.5Ah / 13.7A | 5Hr, 1,80V/cell, 25°C |
| | 60.0Ah / 20.0A | 3Hr, 1,80V/cell, 25°C |
| Curent maxim de descarcare | 46.0Ah / 46.0A | 1Hr, 1,75V/cell, 25°C |
| | 700A (5s) | |
| Rezistenta interna | Approx 5.50mΩ | |
| Interval temp. de utilizare | Descarcare: -15 ÷ 50°C | |
| | Incarcare: -10 ÷ 50°C | |
| | Depozitare: -20 ÷ 50°C | |
| Temp. nominala de utilizare | 25 ± 3°C | |
| Utilizare ciclica | Curent initial de incarcare: <24.0A. Tensiunea de incarcare: 14,50V ÷ 15,00V la 25°C. Coef. de corectie cu temp.: -30mV / °C | |
| | Curent initial de incarcare: <24.0A. Tensiunea de incarcare: 13,50V ÷ 13,80V la 25°C. Coef. de corectie cu temp.: -18mV / °C | |
| Utilizare tampon (stand-by) | 4°C | 102% |
| | 25°C | 100% |
| | 0°C | 85% |
| Autodescarcare la 25°C | 1 lun | Capacitate remanenta: 91% |
| | 3 luni | Capacitate remanenta: 82% |
| | 6 luni | Capacitate remanenta: 78% |
| | 12 luni | Capacitate remanenta: 70% |

Utilizari si caracteristici

Tehnologie: VRLA - AGM

Surse neintreruptibile de tensiune (UPS)

Sisteme electrice de alimentare (EPS)

Sisteme de semnalizare aeriene si feroviare

Iluminat de siguranta

Centrale electrice

Sisteme de alarma si securitate

Surse de alimentare cu C.C.

EN 60896-21,-22

Durata de viata proiectata: 10-12 ani

Eurobat: Standard Comercial

Bateriile din gama FOTON FL pot fi stocate pana la 6 luni la 25°C dupa care este recomandata o incarcare de improspatare

Descarcare cu curent constant (Amperi) la 25°C

| Ufinal/Timp | 10min | 15min | 30min | 60min | 2h | 3h | 4h | 5h | 8h | 10h | 20h |
|-------------|-------|-------|-------|-------|------|------|------|------|------|------|------|
| 9.60V | 174 | 134 | 80.4 | 49.4 | 29.2 | 21.1 | 16.8 | 14.4 | 9.87 | 8.14 | 4.32 |
| 9.90V | 169 | 131 | 78.8 | 48.7 | 29.1 | 20.9 | 16.7 | 14.3 | 9.82 | 8.13 | 4.31 |
| 10.2V | 162 | 126 | 76.4 | 47.5 | 28.8 | 20.8 | 16.6 | 14.2 | 9.75 | 8.10 | 4.30 |
| 10.5V | 155 | 122 | 74.5 | 46.0 | 28.4 | 20.6 | 16.5 | 14.1 | 9.68 | 8.06 | 4.27 |
| 10.8V | 146 | 116 | 71.8 | 44.5 | 27.6 | 20.0 | 16.0 | 13.7 | 9.39 | 8.00 | 4.24 |

Descarcare cu putere constanta (Watts/bloc) la 25°C

| Ufinal/Timp | 10min | 15min | 30min | 60min | 2h | 3h | 4h | 5h | 8h | 10h | 20h |
|-------------|-------|-------|-------|-------|-----|-----|-----|-----|-----|------|------|
| 9.60V | 1884 | 1476 | 902 | 564 | 339 | 248 | 198 | 170 | 117 | 97.2 | 51.8 |
| 9.90V | 1827 | 1440 | 884 | 555 | 337 | 246 | 197 | 169 | 117 | 97.0 | 51.7 |
| 10.2V | 1752 | 1387 | 857 | 541 | 334 | 244 | 195 | 168 | 116 | 96.8 | 51.5 |
| 10.5V | 1676 | 1340 | 836 | 524 | 329 | 243 | 194 | 166 | 115 | 96.2 | 51.2 |
| 10.8V | 1582 | 1269 | 806 | 507 | 320 | 235 | 188 | 161 | 112 | 95.5 | 50.9 |

Dimensiuni exterioare (mm)

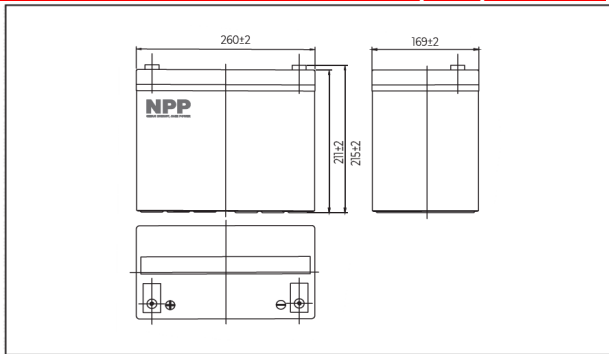

Tip Borna (mm)

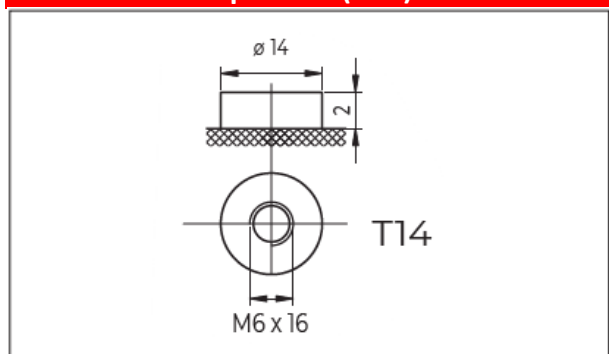

Caracteristici de descarcare (25°C)

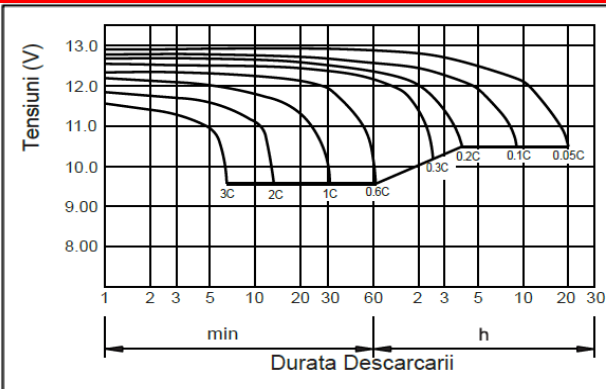

Caracteristici de incarcare (25°C)

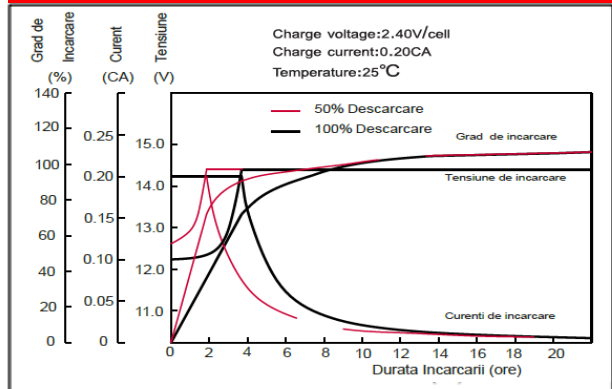

Efectul temperaturii asupra capacitatii

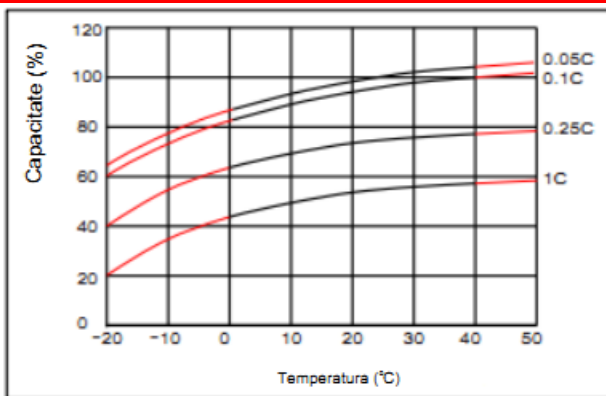

Durata de viata in functie de temperatura

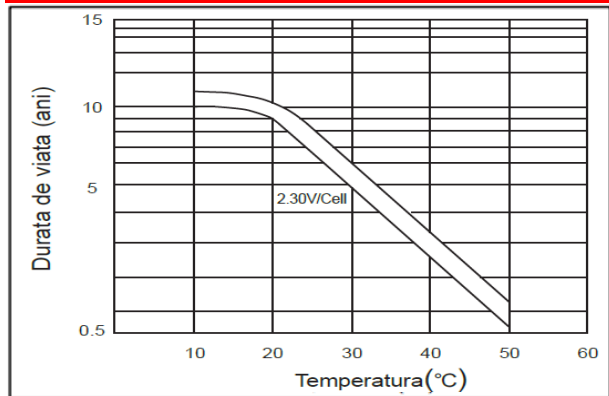

Numar de cicluri vs D.O.D (25°C)

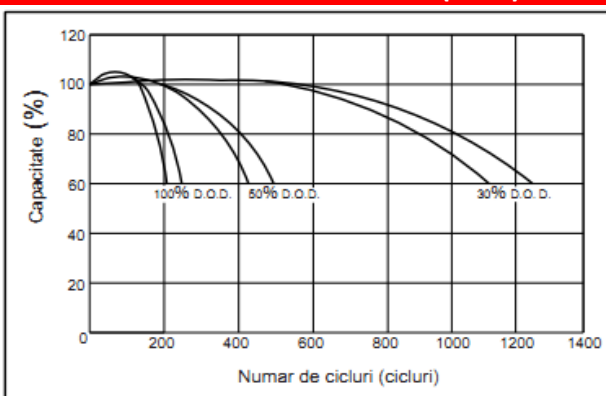

Relatia tensiune la borne / capacitate (25°C)

